



RESIDENTIAL



Bridgewater Wharf Ordsall Lane, Manchester, M5 3WH

£179,950

- Tenant in situ – generating immediate rental income from day one
- Minutes from MediaCity, Salford Quays and major employers including the BBC & ITV
- £1,150 PCM rental income achieving an estimated 7.7% gross yield
- Strong rental demand from young professionals
- Spacious one-bedroom apartment finished to a modern standard
- Excellent transport links via Metrolink, road networks and bus routes

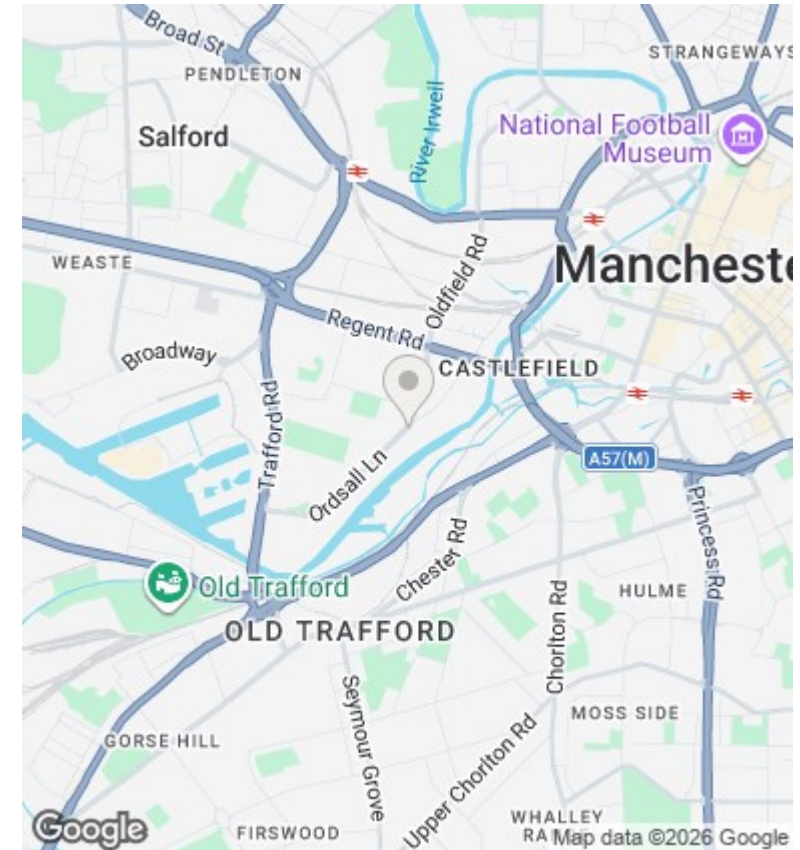
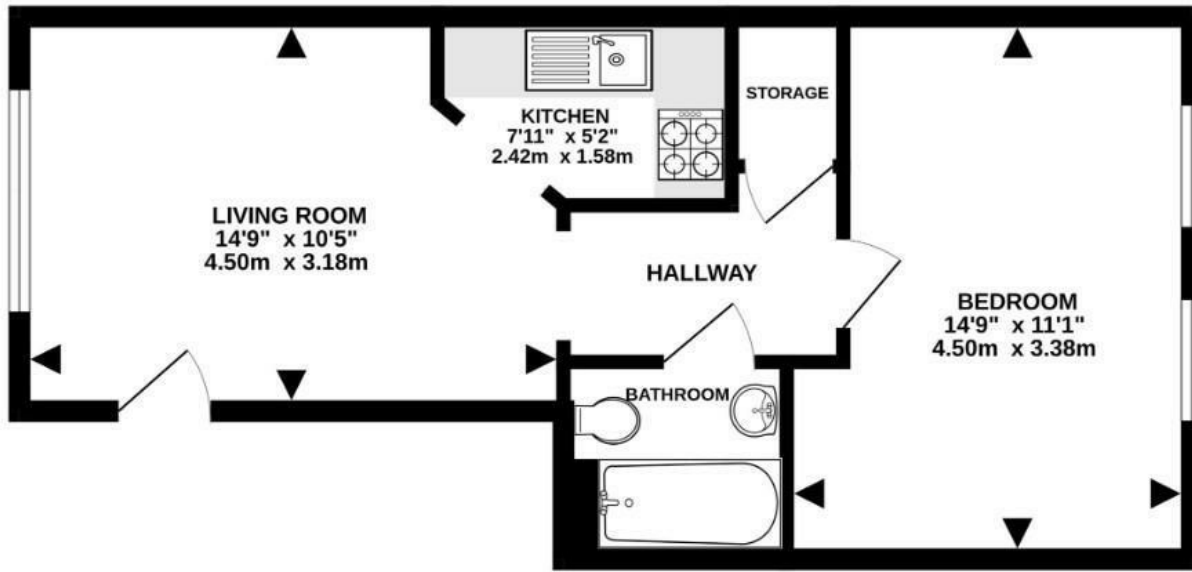

Directions

Viewings

Viewings by arrangement only. Call 0113 3224 345 to make an appointment.

Council Tax Band

EPC Rating:

Energy Efficiency Rating		
	Current	Potential
<i>Very energy efficient - lower running costs</i>		
(92 plus) A		
(81-91) B		
(69-80) C		
(55-68) D		
(39-54) E		
(21-38) F		
(1-20) G		
<i>Not energy efficient - higher running costs</i>		
England & Wales	EU Directive 2002/91/EC	